

-370 Dudley Chase to Alonzo Dabell, Apr. 8-1889.
 100 Pt N. E. 1/4 Sec. 1, T. 6. N. R. 2. W., Beg. 5.82 ch. N.
 of S.W. cor. 1/4 \overline{E} 3.09 ch, $N15^{\circ}15' W.$ 7.44 ch, $N48^{\circ}50' E$
 2.61 ch, to cent. Str. $N50^{\circ}28' W.$ 4.02 ch. along cent.
 Str. & W. line 1/4 \overline{S} 11.45 ch to beg.

Feb. 16. - 1893.

Survey of part of South
 Ogden, Plat B.

for S.C. & W.J. Stephens.

W. La France, assz.

see book I. field notes
 page 92. For locat.
 = 102 of this point.

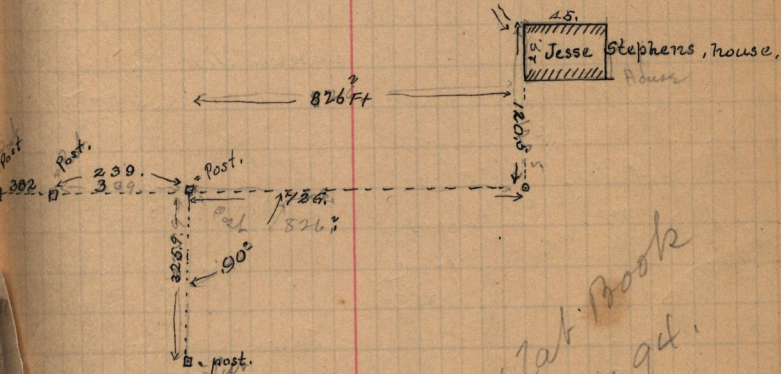

see Plat. Book
 page 94.